

EN



OBDDelevenTM

USER MANUAL

Smart diagnostic tool for understanding
and improving your vehicle.

IMPORTANT SAFETY INSTRUCTIONS



- Do not disassemble the device! Any changes or modifications could void the warranty and user's authority to operate this equipment.
- All wireless data transferring devices produce interference that may affect other devices which are placed nearby.
- Do not use OBDeleven if it distracts driver or causes inconvenience due to OBD II placement. Device must not interfere with driving or driver.
- Please consult representatives of your vehicle model regarding OBD II location on your vehicle. In case you are not sure of proper connection, please consult qualified personnel.

IMPORTANT SAFETY INSTRUCTIONS



- The device is susceptible to water and humidity.

ATTENTION!

- **The device uses SELV limited power source. The nominal voltage is 12 V DC. The allowed range of voltage is 10 V...30 V DC.**

IMPORTANT SAFETY INSTRUCTIONS



- Do not disassemble the device! Any changes or modifications could void the warranty and user's authority to operate this equipment.
- All wireless data transferring devices produce interference that may affect other devices which are placed nearby.
- Do not use OBDeleven if it distracts driver or causes inconvenience due to OBD II placement. Device must not interfere with driving or driver.
- Please consult representatives of your vehicle model regarding OBD II location on your vehicle. In case you are not sure of proper connection, please consult qualified personnel.

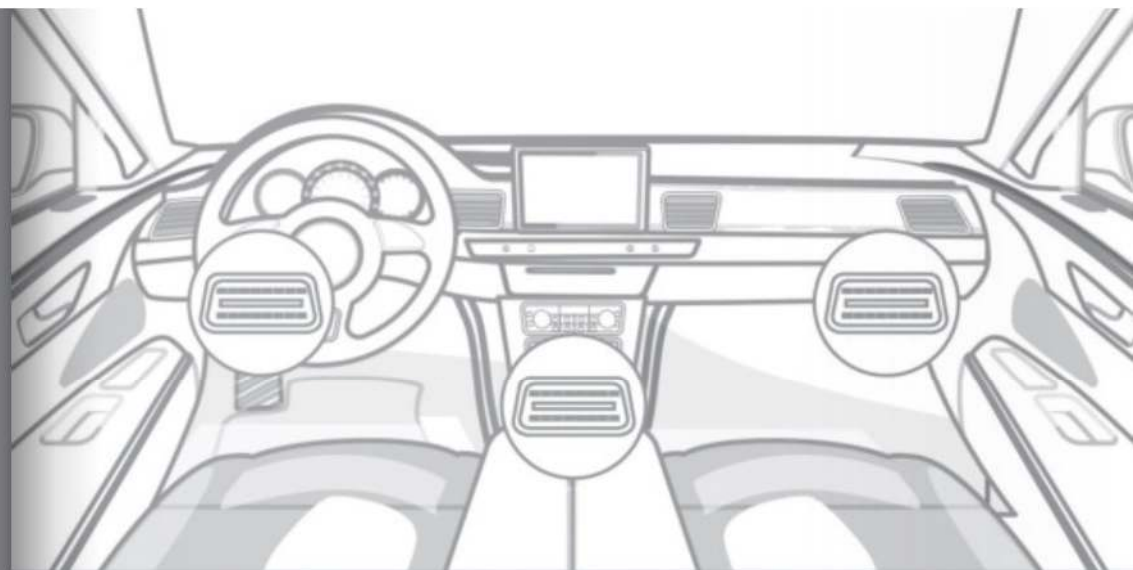

QUICK START

- Plug the device into **OBD II** port.
- Turn on the ignition or start the engine.
- Make sure the power **LED** on the device is on.

The **OBD II** port is usually located under the dashboard or in the left side beneath the steering wheel column. It may also be located behind a latch or contain a cover.

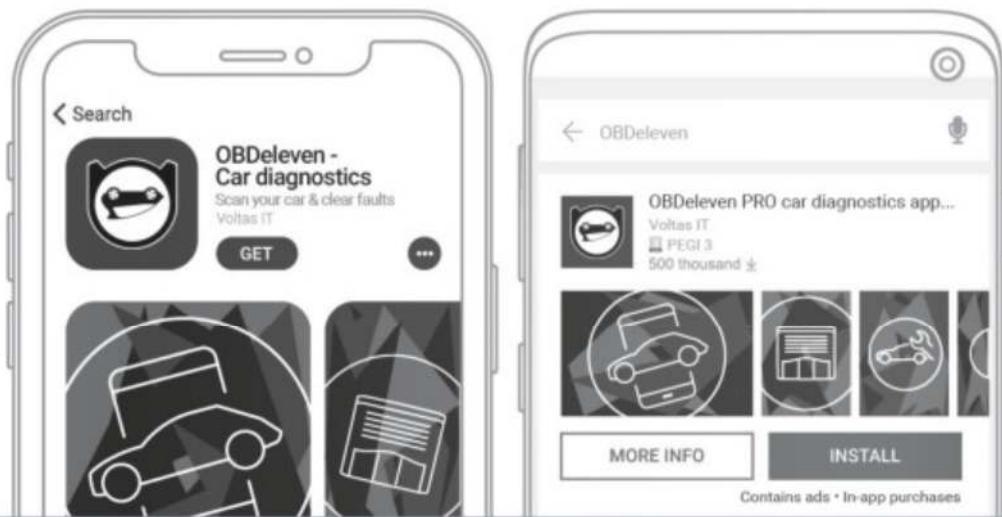

- Download application from **App Store** (for iOS devices) or **Google Play** (for Android devices).



Available on the
App Store



GET IT ON
Google Play

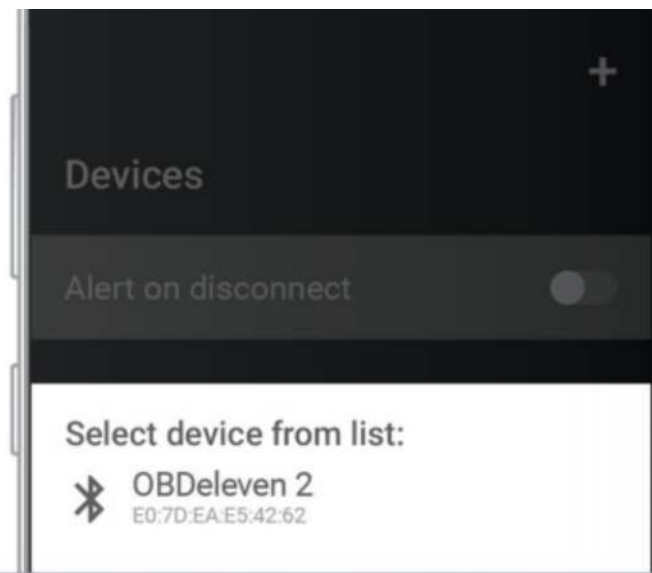

ADD DEVICE AND CONNECT TO YOUR CAR

- Go to **Settings** (Android) or **Other** (iOS) and select **Devices**
- Press **+** icon
- Select the **OBDeleven 2** option from the list.
- Press **Connect** from homescreen

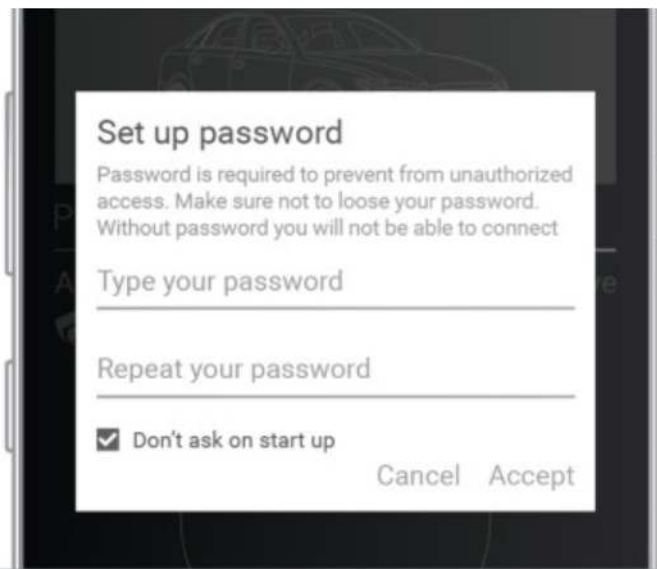

CREATE DEVICE PASSWORD

- Enter 6 digit code to create unique device password.

This will help you to protect and secure your vehicle from unauthorized access.

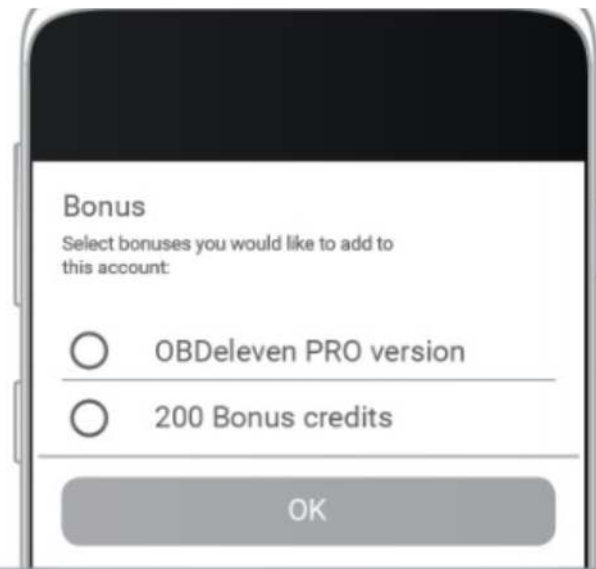

ADD PRO LICENSE AND CREDITS TO YOUR ACCOUNT

Select which items you want to use on the connected OBDeleven account.



ONE-CLICK APPS AND CREDITS

Package includes credits, which enables to use one click coding features such as:

- Activate new functions
- Disable unwanted ones
- Unlock cool visual features **and more...**

Full list: <https://obdeleven.com/features>

COMPATIBILITY

To check full list of supported vehicles and features, go to <https://obdeleven.com/supported-vehicles> or check "Supported vehicles" section in OBDeleven application.

REQUIREMENTS

- **iOS 11** or newer supported phones/tablets
- **Android 5.0** or newer phones/tablets



OBDeleven SPECIFICATIONS

Size

41 x 33 x 24 mm

Weight

25 g

Idle Power Consumption / Max Power Consumption

0.42 W / 0.54 W

Input Current

45 mA

Input Voltage

12 V

Bluetooth

4.2

Colour

Black



TROUBLESHOOTING TIPS

1. Can't find or pair to OBDeleven device:

- Make sure that power LED on device is active
- Disable and then enable phone/tablet Bluetooth
- Restart your phone/tablet
- Search the device with vehicle ignition turned off
- Make sure that your phone is not connected to any other Bluetooth device (car media, hands-free etc.)
- Try to unpair all paired devices

2. Device is plugged into the vehicle and indicator light is not turning on:

- Please contact: support@obdeleven.com



RETURN POLICY

- We are accepting 14 days return policy. Item must be returned in original package and without marks of use.
- Hardware or accessories, purchased online, may be opened for the purpose of inspection (but not used) and may be returned for refund or exchange within 14 days of the dispatch date.
- Virtual items as PRO version activation or Credits can't be returned for refund.
- We are unable to refund postage and packaging costs incurred for returning unwanted products for international or Lithuanian orders.
- Items bought as part of a bundle (including PRO license or credits, hardware and software packs) if returned digital content used, will result in the full price being charged for other items in the bundle. Your refund will be adjusted accordingly.
- If returning hardware, it must contain all the components.

WARRANTY

Voltas IT guarantees its products to be free of any manufacturing defects for a period of 24 months. If a product should fail within this specific warranty time, the product can be:

- Repaired
- Replaced with a new product

This warranty does not apply to Products you purchased from unauthorized resellers, or where instructions for use or activation of the Product are not complied with or where Product is damaged as a result of abuse, accident, modification or other causes beyond our reasonable control. Any replacement product will be warranted for the remainder of original warranty period or 90 calendar days, whichever is longer.



HOW TO SUBMIT A WARRANTY CLAIM

To obtain warranty service, contact us via our help platform:
<https://obdeleven.com/faqs/help>.

Instructions will follow on how to submit your claim.

- You will be responsible for securely packaging the Hardware and including the requested information, such as account verification information.
- You are also responsible for all shipping and handling charges, in addition to any applicable customs duties, VAT or other associated taxes or charges when returning the Hardware.
- Hardware for which Voltas IT cannot reproduce the claimed defect or for which your purchase cannot be verified will be rejected.

For more detailed information about Warranty please visit:
<https://obdeleven.com/warranty>

VOLTAS *IT*

Manufacturer: Voltas IT, LLC
Developed by Voltas IT, LLC in Lithuania,
assembled in Lithuania.

Trademark OBDeleven and Voltas IT, LLC. All rights reserved.

